

2019 Lagoon 50 OUT OF THE BLUE



Basic Vessel Summary

Manufacturer:	LAGOON
Model:	Lagoon 50
Model Year:	2019
Year Built:	2018
Type of Yacht:	Sail
Price:	Price on Application
Condition:	New
Status:	Sold
Location	Tortola Virgin Islands (British)
Manuf. Length:	48' 2" (14.68 m)
Maximum Draft:	4' 6" (1.37 m)
Minimum Draft:	4' 6" (1.37 m)
Beam:	26' 5" (8.05 m)
LWL:	' (14.94 m)
No. of berths:	6
No. of Cabins:	4
No. of Heads:	4
Fuel Capacity:	126 g
Water Capacity:	137 g
Weight - Displacement:	21 ton (42000 lb)
Hull Material:	Fiberglass Reinforced Plastic- FRP
Hull Configuration:	Catamaran

Full Specification

Layout & Accommodations

The spaciouly designed layout reveals innovative architecture where every detail has been planned to create a warm, homely atmosphere. The design enables anyone to choose their desired accommodation layout, with three, four, five or even six cabins

An innovative saloon concept on two levels, providing two separate but communicating areas: a large galley that opens onto the cockpit on one side, and a slightly elevated lounge area for enhanced panoramic vision, which can easily be turned into a dining area if needed. An innovative interior design, with a new, elegant and elaborate wood finish to be customised for the owner.

Remarkable communication between the interior and the exterior: the central panoramic windscreen is retractable, which is ideal for ventilation of both the saloon and the cockpit. This enables interaction with the forward area.

Outstanding natural light in the aft cabins, fitted with panoramic glazing and large hull portholes in the showers and bathrooms.

Volume and comfort in the hulls with particular attention to storage space: cabins with « Island bed » berths forward and aft, large storage volumes, hanging lockers, and open bookcases.

Large fresh and black water tanks located under the floorboards, thus providing considerable space. A grey water tank is optional in order to comply with environmental standards.

Deck & Equipment

A flybridge with two secure accesses and a helm station provides perfect visibility. And behind the helm station, a huge modular recreation area conceals a storage area large enough to store all the cushions.

A large open cockpit facing out to sea, large stern skirts enable easy access to the boat and a large modular dining area with removable bench seats to welcome children and adults alike.

A second cockpit for further enjoyment of the foredeck with dual function: seating or deck chair position, flush with the forward trampoline.

Vast storage space under most of the cockpit and flybridge seats.

Sails & Rigging

The decision to position the mast step further aft, which stems directly from VPLP's experience in competitive sailing, provides this catamaran with multiple advantages.

A self-tacking jib for simplified maneuvers.

A large forward triangle for a wider choice of downwind sails: a guaranty of performance,

A shorter boom for easier maneuvers.

A main sail, with a high aspect ratio, enabling the capture of better airflow in the upper parts of the sail for optimized performance.

The re-centering of weight, thanks to aft positioning of rigging, considerably reduces the boat's pitch.

Image Gallery



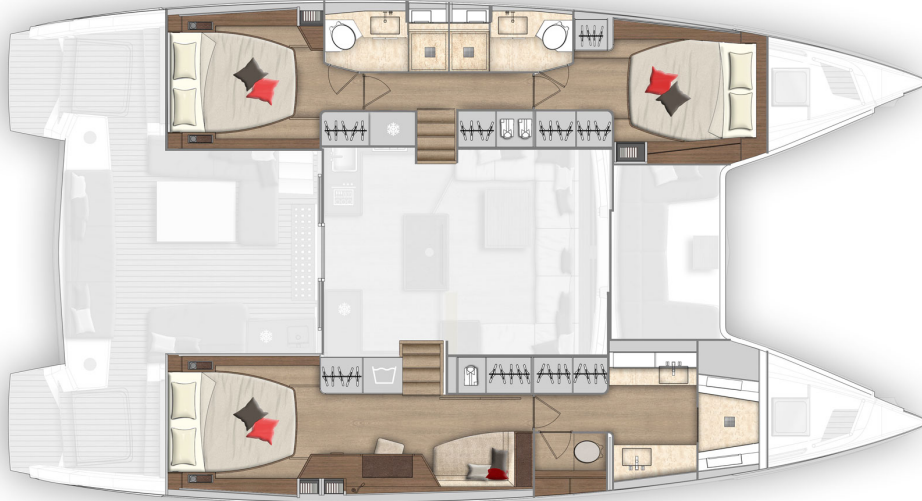

3 cabines 3 Salles de bain / 3 cabins 3 bathrooms

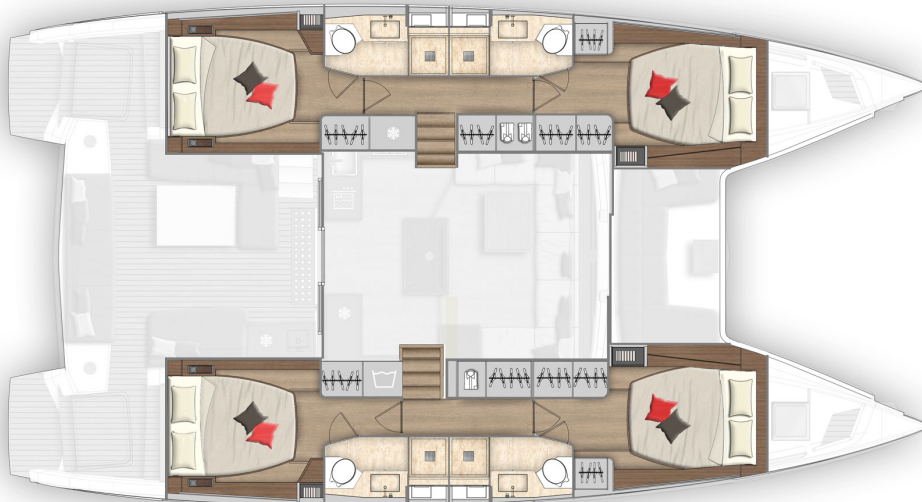

4 cabines 4 Salles de bain / 4 cabins 4 bathrooms

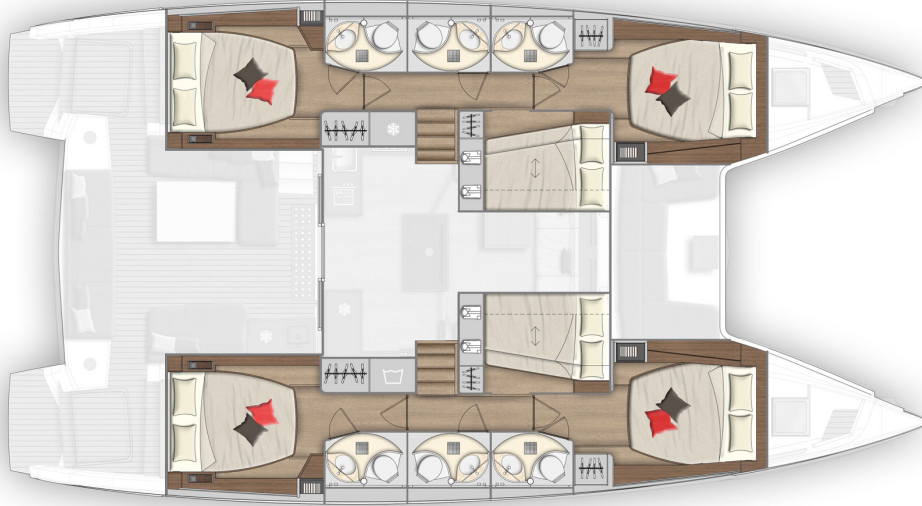

6 cabines 6 Salles de bain / 6 cabins 6 bathrooms



Carré et cockpit / Saloon and cockpit

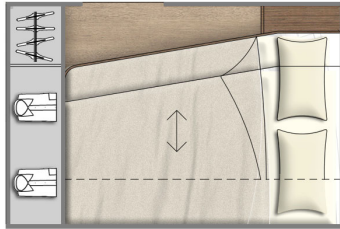

Cabine centrale bâbord ou tribord (option sur version 3 ou 4 cabines)
Central cabin on portside or starboardside (option for 3 or 4 cabin versions)

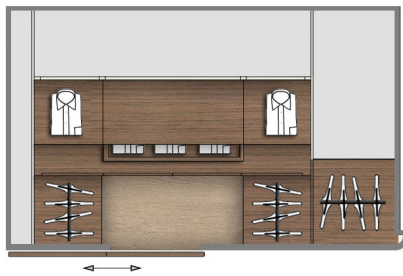

Grand dressing tribord (option sur version 3 ou 4 cabines)
Large dressing room on starboardside (option for 3 or 4 cabin versions)



Disclaimer

The Company offers the details of this vessel in good faith but cannot guarantee or warrant the accuracy of this information nor warrant the condition of the vessel. A buyer should instruct his agents, or his surveyors to investigate such details as the buyer desired validated. This vessel is offered subject to prior sale, price change, or withdrawal without notice. Photos may not properly reflect the current condition of the actual vessel offered for sale. In some cases stock photographs may have been used.

Mechanical Disclaimer

Engine and generator hours are as of the date of the original listing and are a representation of what the listing broker is told by the owner and/or actual reading of the engine hour meters. The broker cannot guarantee the true hours. It is the responsibility of the purchaser and/or his agent to verify engine hours, warranties implied or

otherwise and major overhauls as well as all other representations noted on the listing.

Dinghy Disclaimer

All dinghies are considered separate vessels and should have separate titles and documents. There is no guarantee as to the title of the dinghy on this vessel so Buyer accepts that while he may receive the dinghy included in the transaction, he may not receive the proper title to it.