

## 2003 Wildcat 350 SIRENITA



### Basic Vessel Summary

<b>Manufacturer:</b>	CHARTER CATS SA
<b>Model:</b>	Wildcat 350
<b>Model Year:</b>	2003
<b>Year Built:</b>	2003
<b>Type of Yacht:</b>	Sail
<b>Price:</b>	\$139,000
<b>Condition:</b>	Used
<b>Status:</b>	Sold
<b>Location</b>	Providenciales Turks & Caicos
<b>Manuf. Length:</b>	37' ( 11.28 m)
<b>Minimum Draft:</b>	3' 3" ( .99 m)
<b>Beam:</b>	21' 6" ( 6.55 m)
<b>Mast Height Clearance:</b>	43' 2" ( 13.16 m)
<b>No. of Cabins:</b>	4
<b>No. of Heads:</b>	2
<b>Fuel Capacity:</b>	60 g
<b>Water Capacity:</b>	60 g
<b>Weight - Displacement:</b>	5 ton (10000 lb)
<b>Hull Material:</b>	Fiberglass Reinforced Plastic- FRP
<b>Hull Configuration:</b>	Catamaran
<b>Engine Manufacturer</b>	Yanmar
<b>Engine Model</b>	3GM30FC
<b>Engine Year</b>	20003
<b>Engine Horsepower</b>	27
<b>Engine Hours (Port)</b>	1550

<b>Engine Hours (Starboard)</b>	1425
<b>Engine Type</b>	Inboard
<b>Engine Fuel Type</b>	Diesel
<b>Does the boat have a generator?</b>	No
<b>Does a dinghy come with the boat?</b>	Yes
<b>Dinghy Model</b>	Carib L9
<b>Dinghy Length</b>	9
<b>Dinghy Model Year</b>	2007
<b>Dinghy Outboard Manufacturer</b>	Mercury
<b>Dinghy Outboard Horsepower</b>	5
<b>Dinghy Outboard Year</b>	2007

## Full Specification

### Layout & Accommodations

PORT HULL: Fwd Head with Shower & Vanity, followed immediately by Fwd Port Cabin with Queen Berth and generous storage lockers and drawers. Aft to Navigation Station [with steps up to Bridge Deck Salon], further aft to Owners' Cabin with Queen Berth and adjacent storage and lockers.

STBD HULL: Mirrored layout of PORT HULL with the exception of Well equipped Galley in place of Navigation Station.

Bridge Deck Salon boasts central Dinette, and wraparound Settee layout.

Spacious cockpit seating with seats and table

Interior Construction/Wood: South African White Oak with Teak & Holly Sole

New Upholstery

Headroom: 2m

4 cabins each equipped with a Queen Berth

Multiple hanging and storage lockers

2 Heads with Vanity and Showers

Auto/electric pump out for showers

12v Lighting and Fans

### Galley

Spacious galley in starboard hull

Fridge (20"x32") and freezer under seat (30"X18"X14") install in 2010

2 burner propane stove

### Deck & Equipment

Rigid bimini top

The stern was lengthen from 1 meter for more stability in 2007

Deck light

4 turbo fans

Window with Lexan ( oct 2013)

Interprotect 7 coats (oct 2013 )

Antifouling 2 coats ( dec 2014)

Chartplotter Raymarine A77 Wifi (may 2013)

Digital color radar 4 kw (sept 2013)

Outdoor VHF ( jan 2014)

Rebuilt anchor motor and change bracket

Ritchie compass (oct 2013)

Check up motor : new belts, oil filters,hose zinc anode(2014)

4 fenders (oct 2013)

Inspection rigging (nov 2013)

Inspection sail and repair (may 2013)

New Trampoline (nov 2013)

Rebuilt kit for two bathroom (dec 2013)

Buffing and polish gel coat (oct 2014)

2 anchors with 200' of chaing

## Electronics & Navigation

Raymarine A77 Wifi chartplotter multifunction touch screen with 2015 Carib and World card except north America

Multifunction screen I70 2014

Windmeter 2014

Autopilot ACU-200 P70 hydraulic with gyro 3D 2014

Radar digital color 18" (2013)

Epirb 406 Mhz

Safety gear: 6 life jackets, flares, search light, flag, firstaid kit, etc.

## Electrical, Power & Plumbing

500 watt solar panel with booster controller

Wind generator Kiss energy hi output 15 amp

110v & 12v breaker panel

Inverter xantrex 1000W

2 8D AGM house battery (dec 2013)

Solar panel 150W (jan 2014)

Bilge pump and shower pump (may 2013)

Echo Tec 24gph watermaker

Water heater

Dinghy and Outboard (Available separately: ask Broker for Details)

## Engine & Mechanical

Fresh water cooled 3-cylinder Yanmar 3GM30

## Sails & Rigging

Mainsail

Genoa

Storm Jib

Spinnaker

New lines 2010

Image Gallery













































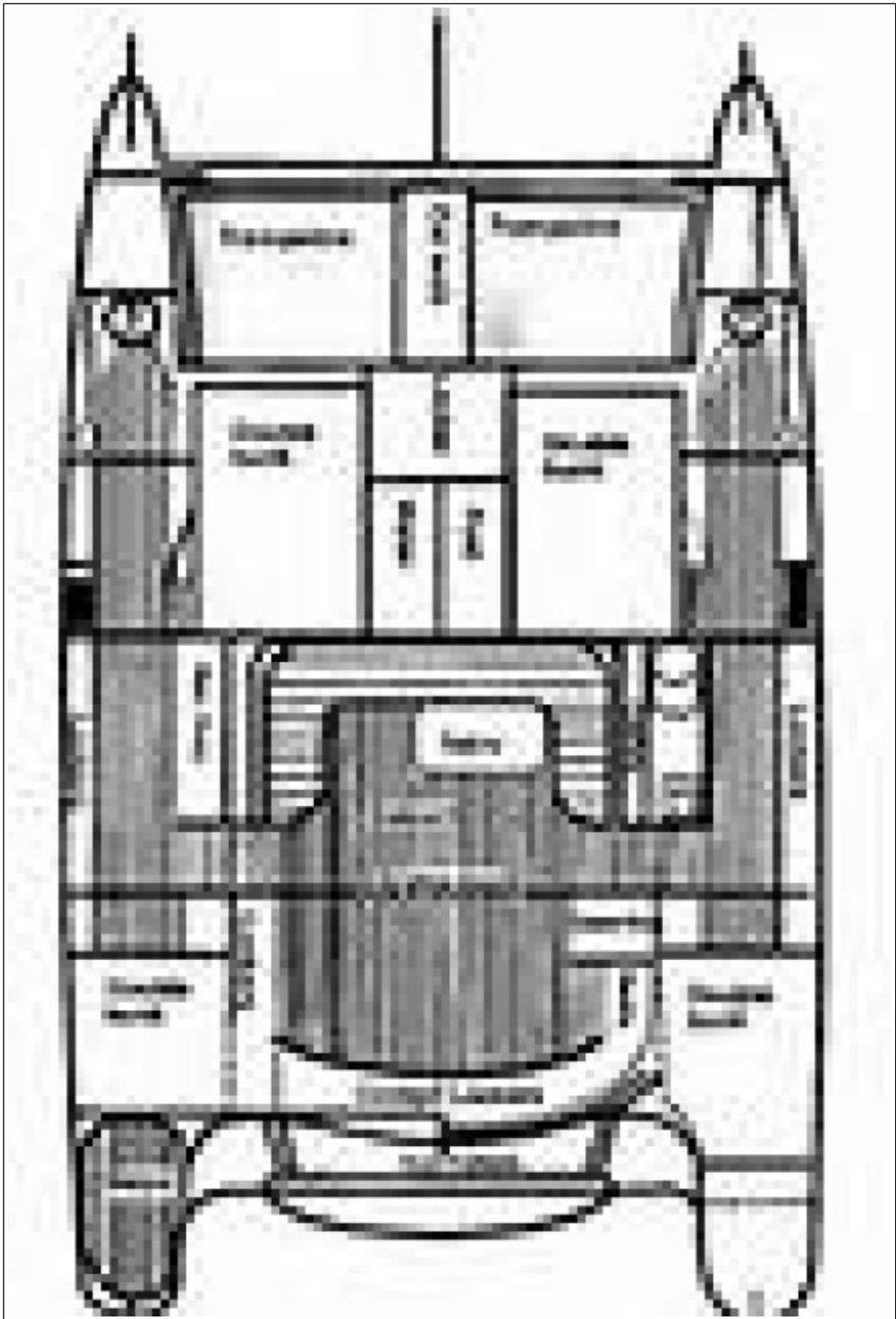

































### **Disclaimer**

The Company offers the details of this vessel in good faith but cannot guarantee or warrant the accuracy of this information nor warrant the condition of the vessel. A buyer should instruct his agents, or his surveyors to investigate such details as the buyer desired validated. This vessel is offered subject to prior sale, price change, or withdrawal without notice. Photos may not properly reflect the current condition of the actual vessel offered for sale. In some cases stock photographs may have been used.

### **Mechanical Disclaimer**

Engine and generator hours are as of the date of the original listing and are a representation of what the listing broker is told by the owner and/or actual reading of the engine hour meters. The broker cannot guarantee the true hours. It is the responsibility of the purchaser and/or his agent to verify engine hours, warranties implied or otherwise and major overhauls as well as all other representations noted on the listing.

### **Dinghy Disclaimer**

All dinghies are considered separate vessels and should have separate titles and documents. There is no guarantee as to the title of the dinghy on this vessel so Buyer accepts that while he may receive the dinghy included in the transaction, he may not receive the proper title to it.