

2025 FP Samana 59 THERAPY



Basic Vessel Summary

Manufacturer:	FOUNTAINE PAJOT
Model:	FP Samana 59
Model Year:	2025
Year Built:	2024
Type of Yacht:	Sail
Price:	\$2,997,500
Condition:	New
Status:	Acceptance of Vessel
Location	Edgewater Maryland (MD)
Duties:	NOT FOR SALE IN US WATER TO USA CITIZENS OR RESIDENTS
Manuf. Length:	59' 0" (17.98 m)
Maximum Draft:	5' 5" (1.65 m)
Minimum Draft:	5' 5" (1.65 m)
Beam:	31' 04" (9.55 m)

No. of Cabins:	5
No. of Heads:	5
Fuel Capacity:	317 g
Water Capacity:	304 g
Weight - Displacement:	28.2 ton (56400 lb)
Hull Material:	Fiberglass Reinforced Plastic- FRP
Hull Configuration:	Catamaran
Engine Manufacturer	Yanmar
Engine Model	4LV150
Engine Year	2024
Engine Horsepower	150
Engine Hours (Port)	240
Engine Hours (Starboard)	240
Engine Type	Inboard
Engine Configuration	Twin
Engine Fuel Type	Diesel
Engine Condition	New

Boat Description:

Discover the Samana 59, a luxurious Fountaine Pajot catamaran for sale, offering a rare 5-cabin, 5-head layout with a galley up.

Designed for those who crave both comfort and sophistication, this sailing yacht redefines onboard living. Boasting the largest flybridge in its class and an expansive 27.5m² cockpit, it delivers the perfect setting for entertaining or relaxing in total serenity. The meticulously crafted interiors combine elegance with functionality, making every passage an elevated experience.

Whether you're planning coastal escapes or bluewater adventures, the Samana 59 promises unmatched performance, space, and sailing freedom.

Full Specification

Layout & Accommodations

SAMANA 59 MAESTRO -COMFORT VERSION

Version configuration :

Curtains in cabins

Mooring kit + 6 fenders

Genoa electrical furler

CST mainsail full batten
Lazy jack
Electrical windlass 2300 Watts
1 electrical winch for main halyard
Two pulpit seats
Hot/cold water on 1 deck shower
Dralon protective cover for wheel
Multiplexage
VHF mast head antenna prewired
Lazy bag
Outdoor cushions
Interior courtesy lighting
Exterior courtesy lighting
2 Genoa electric winches
1 Main sheet electric winch
Pressurized seawater system (2 outlets)
Main grid 220V 60HZ
Charger/inverter 5000W/120 A 50/60HZ
Additional electric freshwater pump
Audio & Video pack saloon (TV 50") (TV system PAL & SECA)
Solar panels 3 x 170 W
Kitchen furniture on fly bridge

Saddlery:

Grey outdoor upholstery
Marble color fabric indoor upholstery

Interior Equipment:

Port fore peak fitting out (bed + head)
Starboard fore peak fitting out (bed + head)

Galley

Additional 220V 90L - 5°C cold Storage for galley up
45L Combination microwave oven (50/60Hz)
Dishwasher 12 place settings
Sink grinder

Deck & Equipment

Exterior Equipment:

Natural wood floor cockpit

Natural wood on flydeck
Cockpit fridges 65 L
Icemaker (cockpit)
Exterior fresh water (2 outlets)

Electronics & Navigation

Aft camera
Pack Garmin 3 : 2 screens 22" - helm station + chart table
Radar

Navigation:

Canoë boom with lazy bag
Windlass control on helm station
Tenderlift hydraulic platform (350kg max) with dinghy removable brackets
Antifouling, primary epoxy

Electrical, Power & Plumbing

5- fresh water electric head guest cabin
Full air conditioning

Electricity & lighting:

Underwater lighting 2x50 W
Additional AGM battery 24V - 150AH
Solar panels 3 x 170 W (Incl.Cft)
110V plugs in addition
Watermaker 220L/H - 220V
Galvanic isolator

Engine & Mechanical

2 engines YANMAR 4LV150
YANMAR engine throttle - chart table
1 bow thruster in starboard hull
24V diesel transfer pump
Mechanical ventilation for all cabins

Additional Information

60HZ OPTIONS:

US gas pre-installation
Additional shore plug 220V-60Hz US Shore Power
110V plugs in addition

VHF US channels (Req. Garmin Pack)

17 kW 220V 60HZ genset

Safety:

Safety equipment without life raft

MP8 container liferaft

Ø 14 mm chain + 40 kg anchor

Image Gallery







New 59

Living space:

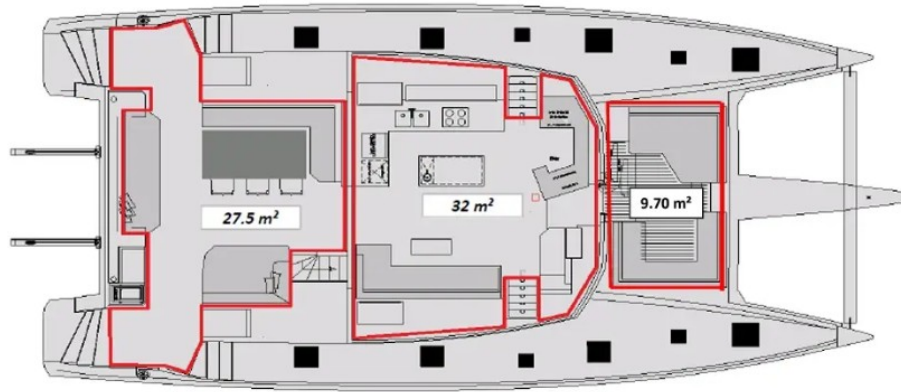

Main deck: 69.2 m²



New 59

Layout Maestro galley up :

























































































Disclaimer

The Company offers the details of this vessel in good faith but cannot guarantee or warrant the accuracy of this information nor warrant the condition of the vessel. A buyer should instruct his agents, or his surveyors to investigate such details as the buyer desired validated. This vessel is offered subject to prior sale, price change, or withdrawal without notice. Photos may not properly reflect the current condition of the actual vessel offered for sale. In some cases stock photographs may have been used.

THIS VESSEL IS NOT FOR SALE IN US WATER TO USA CITIZENS OR RESIDENTS.

Mechanical Disclaimer

Engine and generator hours are as of the date of the original listing and are a representation of what the listing broker is told by the owner and/or actual reading of the engine hour meters. The broker cannot guarantee the true hours. It is the responsibility of the purchaser and/or his agent to verify engine hours, warranties implied or otherwise and major overhauls as well as all other representations noted on the listing.

Dinghy Disclaimer

All dinghies are considered separate vessels and should have separate titles and documents. There is no guarantee as to the title of the dinghy on this vessel so Buyer accepts that while he may receive the dinghy included in the transaction, he may not receive the proper title to it.