

2012 Sunreef 70 MULAN



Basic Vessel Summary

Manufacturer:	SUNREEF
Model:	Sunreef 70
Model Year:	2012
Type of Yacht:	Sail
Price:	\$1,987,000
Condition:	Used
Status:	Catamaran for Sale
Location	Honolulu Hawaii (HI)
Manuf. Length:	71' 5" (21.77 m)
Minimum Draft:	6' 2" (1.88 m)
Beam:	33' 1" (10.08 m)
No. of Cabins:	5
No. of Heads:	5
Fuel Capacity:	1590 g
Water Capacity:	396 g

Weight - Displacement:	34.72 ton (69440 lb)
Hull Material:	Composite
Hull Configuration:	Catamaran
Engine Manufacturer	Yanmar
Engine Model	6B Y2-26
Engine Year	2012
Engine Horsepower	260HP
Engine Hours (Port)	1485
Engine Hours (Starboard)	1485
Engine Type	InBoard
Engine Configuration	Twin
Engine Fuel Type	Diesel

Boat Description:

Perfect 5 cabin layout with the master cabin consisting of the entire starboard side hull. 3 staterooms and 2 crewcabins, each with their own A/C, shower, and head. Originally launched Dec 2012 as hull #10 of the Sunreef 70 series. The second owner (current owner) has enjoyed this boat immensely, only selling due to building another Sunreef. This is a turn-key successful charter yacht currently in high demand, gracing many celebrity guests, currently operating in Honolulu, HI. Fully equipped with all large yacht essentials. 2 bow thrusters, A/C Gen, water-maker, underwater lights, teak decks, solar, wine fridge, folding props, diving board, icemakers, dive compressor, full set of dive gear, electric winches, Furuno electronics, new exterior upholstery, new washer and dryer, onboard fuel polishing system.

Full Specification

Layout & Accommodations

Inside Equipment

- Dishwasher
- Bow Thruster
- Washing Machine
- Electric Bilge Pump
- Oven
- Manual Bilge Pump
- Microwave Oven
- Air Compressor
- Marine Head
- Air Conditioning

- Electric Head
- Heating
- Hot Water
- Refrigerator
- Fresh Water Maker
- Deep Freezer
- Sea Water Pump
- Battery Charger

Galley

Galley up

Deck & Equipment

Deck & Equipment-

Bow pulpits with integrated teak seats

Gangway

Lewmar port lights

Swim ladder on the skirts

Hull side ladder in bow Winches

Blocks and jammers

Genoa manual furler

Deck light

Electric lifting system for the dinghy with extendable arms and remote controller

Hatch at the top of the stairway between cockpit and flybridge

Fresh water hose retrieval & storage system with spray nozzle in chain locker

2 fresh water outlets at the bottom of the mast and in the cockpit Main sail electric winch

Bimini on the flybridge (stainless steel)

2 additional lights for the flybridge + separate switch

4 extra waterproof speakers in the cockpit and flybridge by BOSE

LEDs on the skirts, cockpit and flybridge

2 hand showers on deck

Outside Equipment/Extras-

- Teak Cockpit
- Cockpit Shower
- Teak Sidedecks
- Gangway
- Davit(s)
- Wind Generator

- Tender
- Solar Panel
- Cockpit Cushions
- Swimming Ladder

Electronics & Navigation

Electronics & Navigation-

Compass (size 135 mm)

Chronometer and barometer

Furuno TZTL12F 12" GPS Navigation Plotter Touch Screen (Flybridge/saloon)

Furuno CH300 85/215HZ Dual Freq Sonar (Flybridge/Saloon)

Furuno NAVPILOT 700 Autopilot (Flybridge/Saloon)

Furuno F1501 WIND INDICATOR (Flybridge/Saloon)

Furuno FI503 TRIDATA (Flybridge/Saloon)

Furuno DFF1 DIGITAL FISHFINDER (Flybridge/Saloon)

Furuno DRS4D 4KW UHD RADAR DOME 24" (Mast)

Furuno FA50 AIS CLASS B TRANSPONDER/RECEIVER (saloon)

Furuno HS-2721 VHF with DSC function

All navigation lighting LED

WiFi extender

Fishfinder

STARLINK VOIP system

2 x TVs Main Salon /Master Cabin

Electronics-

- Depthsonder
- Radar
- Log-Speedometer
- Radar Detector
- Wind Speed and Direction
- Computer
- Repeater(s)
- TV Set
- Navigation Center

- Plotter
- DVD Player
- Autopilot
- Radio
- Compass
- CD Player
- GPS
- Cockpit Speakers
- VHF

Electrical, Power & Plumbing

Electrical, Power & Plumbing-

AC-230V: Main panel extension, 3 chargers (24V/100A), Inverter (24V/5000W), two 230V sockets in cabins,

additional sockets in saloon galley

DC-24V: Main panel extension, Battery monitoring, 12 house batteries (24 V/1200Ah), starting batteries

110V shore connection kit

2x Generator 19KW 220V 50HZ (Hours: approx. 1188 each)

2x 350W Wind Generator (Superwind) Ultra quiet

4x solar power 140W (560W total)

Fresh water: 2x 750L equipped with level indicators, 2 pressurized pumps), 2 water heaters of 80L each

Black water: 2x 137L with discharge system, 2 electric pumps with automatic discharge equipped with 3 way

valves (discharge in the sea or holding tanks)

4 electric bilge pumps

2 manual bilge pumps

2 hand showers on deck

Watermaker 220L/h - 220V (Sea Recovery Aquawhisper reverse)

Electric 24V toilets in bathrooms with freshwater flush

Air conditioning 72 000 BTU (Marine Air MCGVLP)

UV sterilizers in AC air handlers

Freshwater Deck-wash system 24v

Electrical Equipment-

- Shore Power Inlet
- Generator
- Inverter

Engine & Mechanical

Engine & Mechanical-

2 x Yanmar 6B Y2-26 Engine Horsepower: 260 Engine hours approx. 1485 each 2x Yanmar KMH50A gearbox

2023: Brand new turbos with new turbo elbow, new V-clamps, new hoses (double clamped);

New engine water pumps

with new hoses, double-clamped, maintained to specifications.

Stainless steel shafts

2 x engine speed controls (one at the navigation table and one on the flybridge)

2 x electric pump + 1 manual for fuel tanks

2 x JABSCO 23870-1300 9GPM 24V Diesel Fuel Transfer Pump

Lights in the engine rooms

Consumption estimation system (Yanmar Digital engine displays)

2x electric bow thrusters (by Max Power CT225, bow thruster 250 mm 440kg thrust)

2x 3000L fuel tanks

Sails & Rigging

Sails & Rigging-

Carbon mast with incorporated LEDs

Carbon boom

Plastic protection on the shrouds

Lazy jack

All sails in good condition

Complete gear for gennaker

Electric furling system for genoa

3 x harken Electric winches, 2 x manual

Rigging inspected Nov 2022, Full survey available

Main Halyard replaced 2022

Rigging-

- Steering Wheel

- Electric Winch

Sails-

- Fully Battened Mainsail

- Furling Mainsail

- Gennaker/Cruising Spinnaker

- Genoa

Covers-

- Bimini Top
- Spray Hood
- Mainsail Cover
- Lazy Bag
- Cockpit Cover
- Lazyjacks
- Genoa Cover

Additional Information

Additional Information-

Victron Quattro 24v /5000/120amp inverter that supplies separate outlets in the cabins and galley.

All hatches re-sealed

12 NEW house bank batteries 2023

Both freshwater pumps rebuilt

Added a 110v system via converter array.

Tender Included: Wilson Diesel Jet 445 in like new condition

Image Gallery













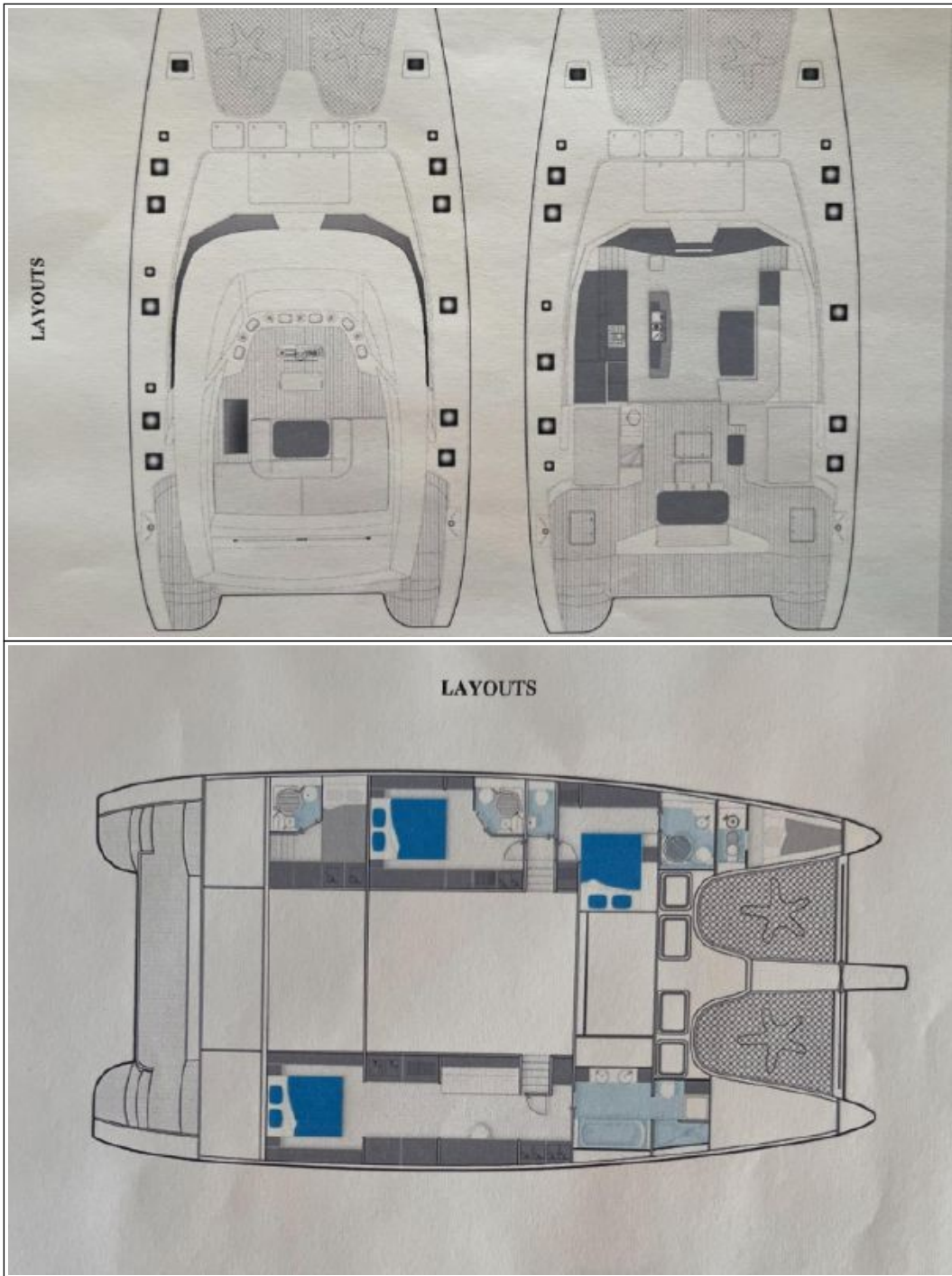

Disclaimer

The Company offers the details of this vessel in good faith but cannot guarantee or warrant the accuracy of this information nor warrant the condition of the vessel. A buyer should instruct his agents, or his surveyors to investigate such details as the buyer desired validated. This vessel is offered subject to prior sale, price change, or withdrawal without notice. Photos may not properly reflect the current condition of the actual vessel offered for sale. In some cases stock photographs may have been used.

Notes: This listing is courtesy of the BoatWizard MLS and may be centrally listed with another broker. It is offered as a convenience by this broker/dealer to its clients and is not intended to convey representation of a particular vessel.

Mechanical Disclaimer

Engine and generator hours are as of the date of the original listing and are a representation of what the listing broker is told by the owner and/or actual reading of the engine hour meters. The broker cannot guarantee the true hours. It is the responsibility of the purchaser and/or his agent to verify engine hours, warranties implied or otherwise and major overhauls as well as all other representations noted on the listing.

Dinghy Disclaimer

All dinghies are considered separate vessels and should have separate titles and documents. There is no guarantee as to the title of the dinghy on this vessel so Buyer accepts that while he may receive the dinghy included in the transaction, he may not receive the proper title to it.