

2018 Lagoon 450 RUM-AWAY



Basic Vessel Summary

Manufacturer:	LAGOON
Model:	Lagoon 450
Model Year:	2018
Year Built:	2017
Type of Yacht:	Sail
Price:	\$495,000
Condition:	Used
Status:	Sold
Location	Tortola Virgin Islands (British)
Manuf. Length:	45' 10" (13.97 m)
Maximum Draft:	4' 3" (1.30 m)
Minimum Draft:	4' 3" (1.30 m)
Beam:	25' 10" (7.87 m)
Mast Height Clearance:	75' 8" (23.06 m)
No. of berths:	6-12

No. of Cabins:	4
No. of Heads:	4
Electric Circuit:	110 volt
Fuel Capacity:	274 g
Water Capacity:	240 g
Holding tank:	4
Weight - Displacement:	16.648 ton (33296 lb)
Hull Material:	Fiberglass Reinforced Plastic- FRP
Hull Configuration:	Catamaran
Engine Manufacturer	Yanmar
Engine Model	4JH57
Engine Year	2018
Engine Horsepower	57
Engine Hours (Port)	1091
Engine Hours (Starboard)	1086
Engine Type	InBoard
Engine Configuration	Twin
Engine Fuel Type	Diesel
Engine Condition	Used
Does the boat have a generator?	Yes
Generator Model	Onan
Generator Operating Hours	5715
Generator Horsepower	14
Does a dinghy come with the boat?	No

Boat Description:

Safety, performance and incomparable cruising comfort with her interior designed by Nauta, best describes this 2018 Lagoon 450F Catamaran Rum-Away for sale. Rum-Away comes with upgraded engines, electric winches and heads, flybridge, cockpit, and forward cockpit: joie de vivre outside.

With 4+2 cabins and 4 ensuite heads, she is perfect for an owner with family and guests or for her owner to use and keep in the charter fleet. She has been professionally maintained in the Catamaran Company Charter fleet.

Full Specification

Layout & Accommodations

EXTERIOR

On deck, the Lagoon 450 catamaran boasts extensive seating both forward of the saloon and aft, as well as a large swimming platform. The raised flybridge with safe access from both

sides of the aft cockpit provides a panoramic bird's eye view at anchor and under sail. With a beam of nearly 26 feet, she is very stable with wide decks and recessed hatches, to make moving around the yacht a breeze and with enough space for everyone aboard to find their own favorite place to read, sunbathe or simply watch the ever-changing seascapes go by.

The spacious aft cockpit comfortably sits all guests around an ample table to make dining al fresco a pleasure. There is a ventilation hatch on the bridge deck, that funnels a cooling breeze into the cockpit area.

INTERIOR

The stylish galley and saloon are tastefully designed and equipped. Full height (6'6") in the galley and saloon. She has a "U"-shaped galley for greater comfort at sea, equipped with broad work space and plenty of storage.

The saloon and cabins exceptionally well lit. The saloon has wrap around windows providing uninterrupted views as well as. This Lagoon 450 also benefits from Air Conditioning powered either by shore power or by a quiet generator, located away from sleeping quarters – making for a peaceful night's sleep. 4 Double cabins provide spacious accommodation for up to 8 adults. Natural light in the cabins thanks to large glazed panels on hulls. Rum-Away also has two forward single berth suitable for either children or crew. Full height (6'6") ensuite separate shower stalls add to the comfort and convenience along with electric heads!

Galley

SEA & FRESH WATER FOOT PUMPS IN GALLEY

ADDITIONAL FRIDGE 34 US GAL

1 ADDITIONAL S/S FRIDGE (in lieu of std) + 1 S/S FREEZER ??

ENO 3-BURNER STAINLESS STEEL STOVE TOP (propane)

ENO GAS OVEN

MICROWAVE

DEDICATED PROPANE LOCKER IN COCKPIT

DUAL BASIN STAINLESS STEEL SINK WITH STAINLESS STEEL FRESHWATER FAUCET

CORIAN COUNTERTOPS

AMPLE STORAGE SPACE

Deck & Equipment

FLYBRIDGE DODGER

HARD FIBERGLASS BIMINI

WINDLESS REMOTE CONTROL WITH CHAIN COUNTER

ALL ELECTRIC WINCHES AT STEERING STATION

PAIR OF STAINLESS STEEL DAVITS

ELECTRIC WINCH FOR DAVITS 40.2SRAEH
ELECTRIC WINCH TO PORT
12V COCKPIT FRIDGE 21 US GAL
LIFERAFT/SAFETY PACK for 8 PAX
HELM STATION CANVAS FLYBRIDGE BIMINI
SUN LOUNGER PADS FOR ROOF
WATERPROOF SPEAKERS IN COCKPIT with REMOTE
DECK COURTESY LIGHTING in TRANSOMS & COCKPIT
NAVIGATION, RUNNING AND MOORING LIGHTS
HELM SEAT CUSHIONS
AFT COCKPIT SEAT CUSHIONS
FORWARD COCKPIT CUSHIONS
COCKPIT COFFEE TABLE
AFT PORTHOLES IN AFT CABINS WITH CURTAINS
PORTHOLE IN GALLEY
FRESHWATER DOCK INLET
DECK WASH DOWN PUMP (SEA OR FRESH WATER)
FORWARD PULPITS WITH WOODEN SEAT
55LB FLAT ANCHOR, 278 FT CHAIN, 65 FT WARP
FENDERS + MOORING ROPES

[Electronics & Navigation](#)

NAVIGATION PACK B&G
B&G ZEUS 12" DISPLAY AT HELM STATION
B&G ZEUS 12" DISPLAY AT NAV STATION
B&G 4G WIFI MODULE
B&G VHF V50
2ND HANDSET AT HELMSTATION FOR VHF B&G
VHF CABLE AND ANTENNA IN MAST

[Electrical, Power & Plumbing](#)

CRUISAIR A/C 48000 BTU 110V
GEL BATTERIES
INVERTER 12/110V
GENSET ONAN 13.5 KVA 110V/60 HZ WITH COCOON
ELECTRIC QUIET FLUSH Heads ALL CABINS
ELECTRIC CIRCUIT WITH 40 AMP BATTERY CHARGER
3 ADDITIONAL SERVICE BATTERIES 140 AMP with 2nd 40AMP BATTERY CHARGER
BATTERY CONTROLLER
50 FT 50AMP 125/250V MARINCO SHORE POWER CORD

EXTRA FRESH WATER TANKS, PORT & STB, 2 x 46 US GAL
FANS IN SALON AND CABINS
FUSION USB PLAYER + 2 SPEAKERS IN SALON

Engine & Mechanical

UPGRADE TO 2 X 57 HP YANMARS 4JH57

Sails & Rigging

DOYLE MAINSAIL CRADLE COVER
US SPARS ANODIZED ALUMINUM MAIN MAST WITH DOUBLE SPREADERS, STEPPED ON-DECK
FRACTIONAL RIG WITH SIDE & FORE DIAMOND STAYS, MAIN STAYS TO CHAIN PLATES
ANODIZED ALUMINUM BOOM
100% GENOA HEADSAIL WITH SUN COVER ON FURLER
FULLY-BATTENED MAINSAIL WITH BALL BEARING LUFF CARS
COMPLETE STANDING RIGGING
1 TWO-PART TACKLE ON MAINSAIL HALYARD
1 TOPPING LIFT
3 REEF PENNANTS
1 GENOA HALYARD
1 SPINNAKER HALYARD
CLUTCHES ON GENOA HALYARD, SPINNAKER AND TOPPING LIFT
CLUTCHES ON REEF PENNANT
1 FLAG HALYARD WITH SPREADERS

Additional Information

Dinghy Sold Separately ask Broker for details.

Bottom Paint May 2019

Image Gallery









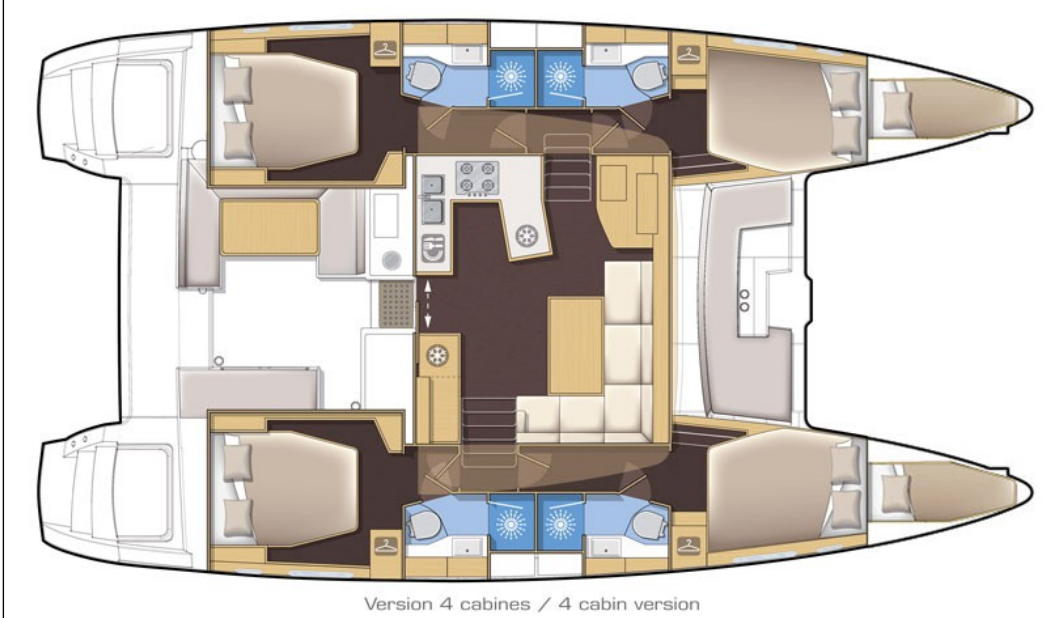

































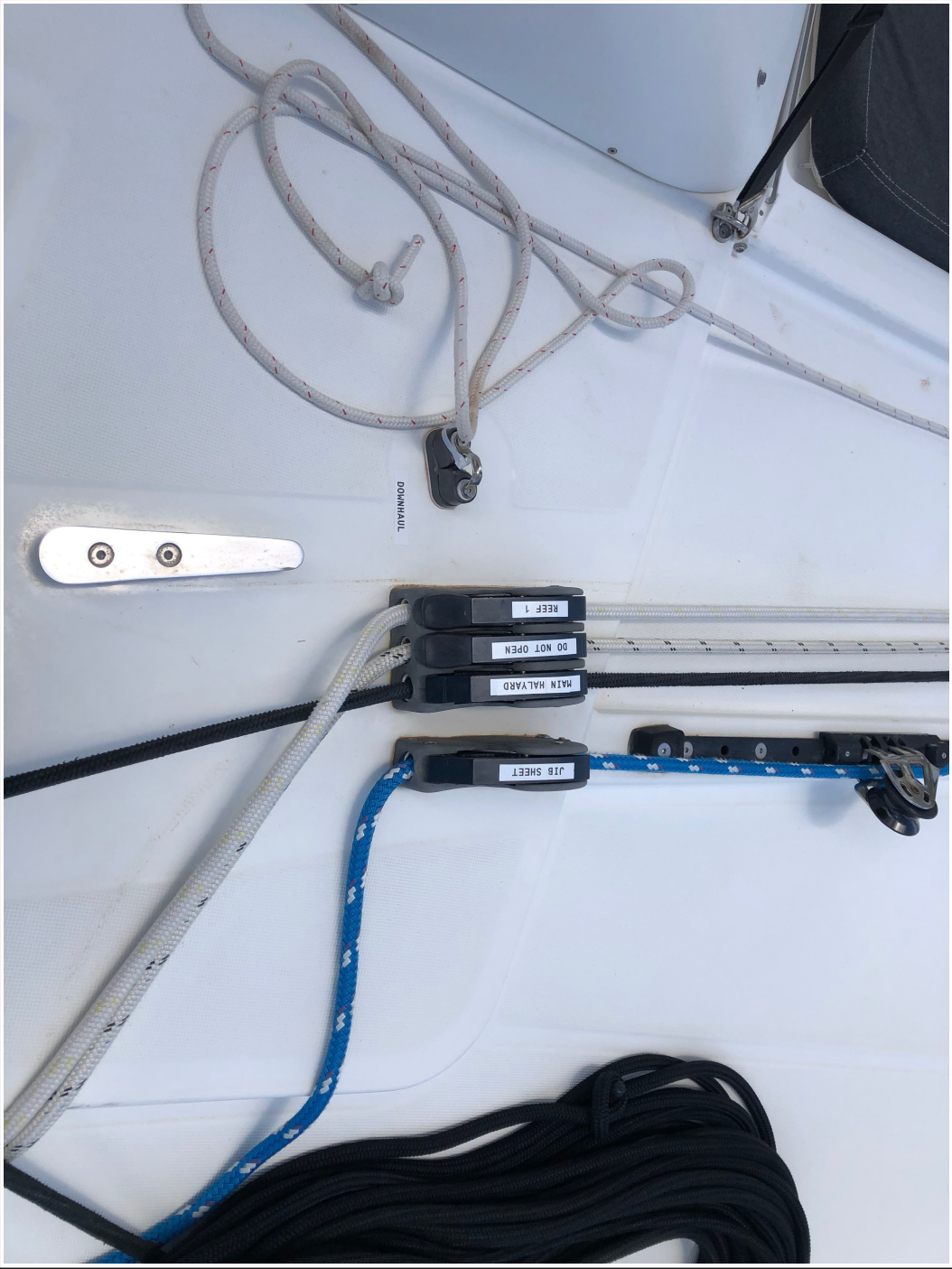

















Disclaimer

The Company offers the details of this vessel in good faith but cannot guarantee or warrant the accuracy of this information nor warrant the condition of the vessel. A buyer should instruct his agents, or his surveyors to investigate such details as the buyer desired validated. This vessel is offered subject to prior sale, price change, or withdrawal without notice. Photos may not properly reflect the current condition of the actual vessel offered for sale. In some cases stock photographs may have been used.

Mechanical Disclaimer

Engine and generator hours are as of the date of the original listing and are a representation of what the listing broker is told by the owner and/or actual reading of the engine hour meters. The broker cannot guarantee the true hours. It is the responsibility of the purchaser and/or his agent to verify engine hours, warranties implied or otherwise and major overhauls as well as all other representations noted on the listing.

Dinghy Disclaimer

All dinghies are considered separate vessels and should have separate titles and documents. There is no guarantee as to the title of the dinghy on this vessel so Buyer accepts that while he may receive the dinghy included in the transaction, he may not receive the proper title to it.