

2025 FP MY 4.S BROCHURE-FOUNTAINE PAJOT MY 4.S



Basic Vessel Summary

Manufacturer:	FOUNTAINE PAJOT
Model:	FP MY 4.S
Model Year:	2025
Type of Yacht:	Power
Price:	Price on Application
Condition:	Brochure
Status:	Catamaran for Sale
Location	France
Manuf. Length:	36' 1" (11.00 m)
Maximum Draft:	2' 7" (.79 m)
Beam:	16' 8" (5.08 m)
Fuel Capacity:	2 x 158 g
Water Capacity:	92 g
Weight - Displacement:	9.5 ton (19000 lb)
Hull Material:	Fiberglass Reinforced Plastic- FRP

Hull Configuration:
Engine Condition

Catamaran
New

[Boat Description:](#)

The Fountaine Pajot MY4.S is the ultimate luxury motor yacht, designed for elegance, performance, and comfort on the water.

CALIFORNIA RETAIL – PURCHASE FOR CHARTER.

This sleek and modern power catamaran offers exceptional fuel efficiency, stability, and speed, making it the perfect vessel for coastal cruising or extended voyages.

With a spacious and well-appointed interior, the MY4.S features a bright and contemporary salon with panoramic windows, a fully equipped galley, and an inviting dining area.

The luxurious cabins provide maximum comfort, with the Maestro version offering an expansive owner's suite, while the Quatuor layout caters to guests with additional accommodations.

Designed for effortless navigation, the MY4.S is equipped with advanced technology, ensuring smooth handling and optimal performance.

The large cockpit and expansive aft deck create the perfect setting for outdoor entertainment, while the swim platform allows easy access to the water for swimming and watersports.

Whether you're seeking a high-end motor yacht for charter investment or personal leisure, the Fountaine Pajot MY4.S delivers an unparalleled yachting experience.

Don't miss the opportunity to own this exceptional power catamaran.

Contact us today to learn more and embark on your next adventure with the MY4.S!

Full Specification

[Layout & Accommodations](#)

2 Version option:

Maestro version

1 owner's suite + 1 bathroom / 2 double cabins + 1 bathroom

Quatuor version

4 double cabins + 2 bathrooms

[Engine & Mechanical](#)

Standard power

YANMAR 2 x 150 HP - 2 x 111 KW

Option power

YANMAR 2 x 250 HP - 2 x 186 KW

[Additional Information](#)

CALIFORNIA RETAIL- PURCHASE FOR CHARTER

Image Gallery







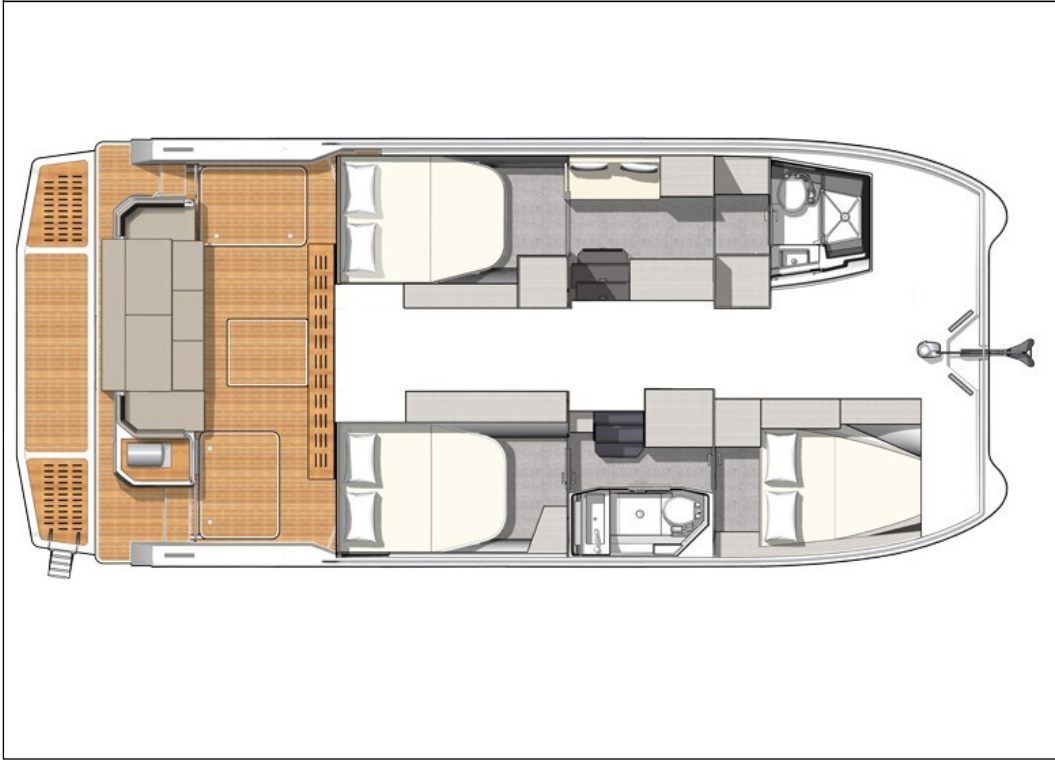

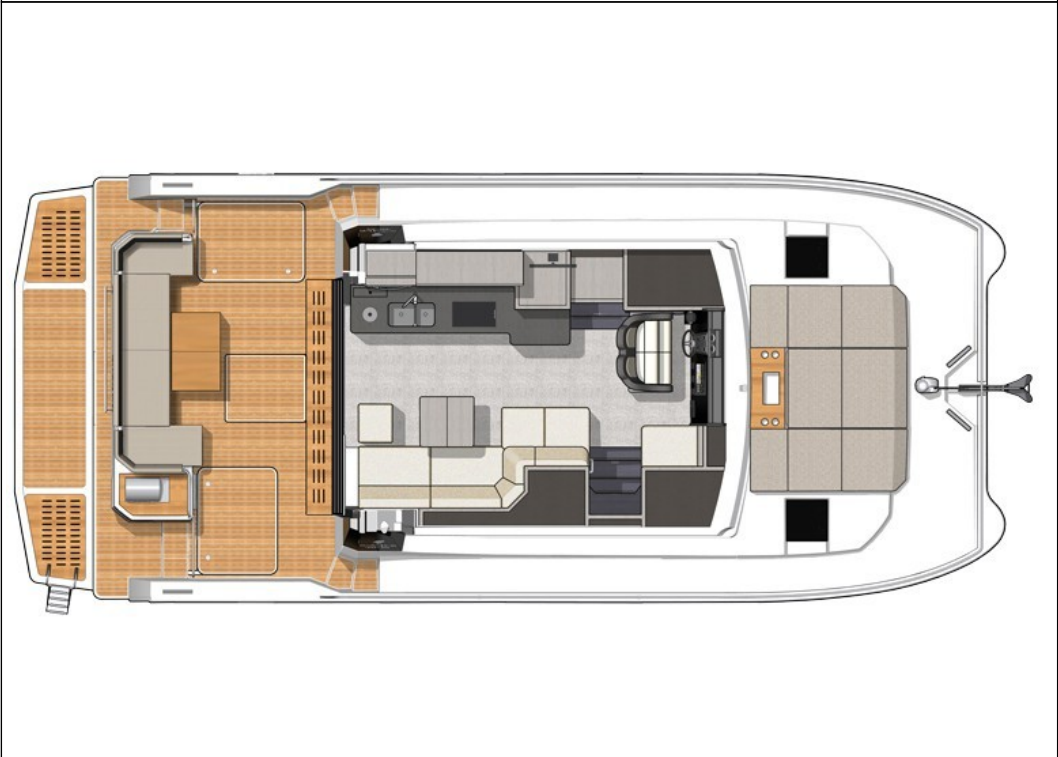
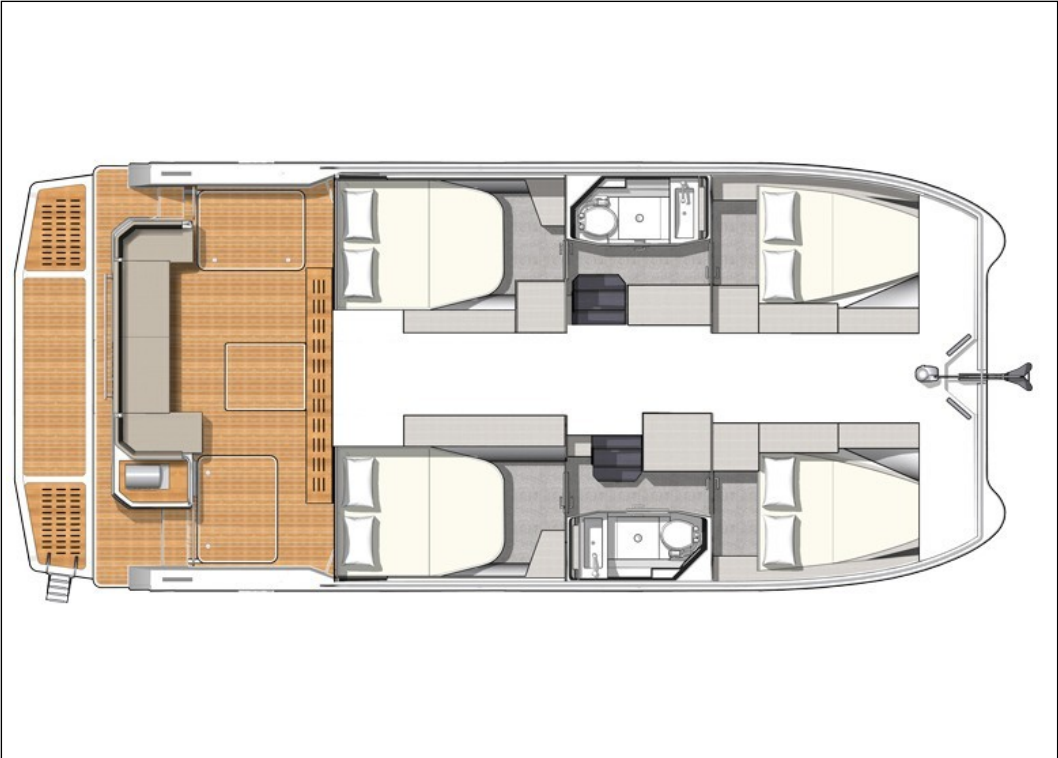

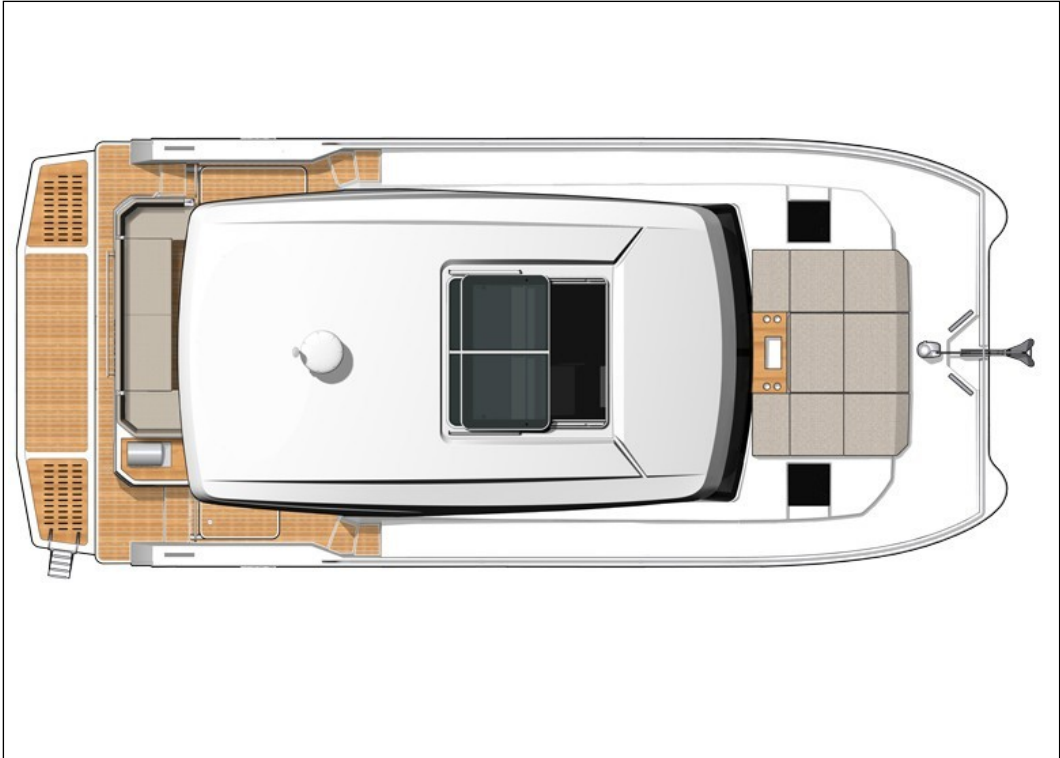





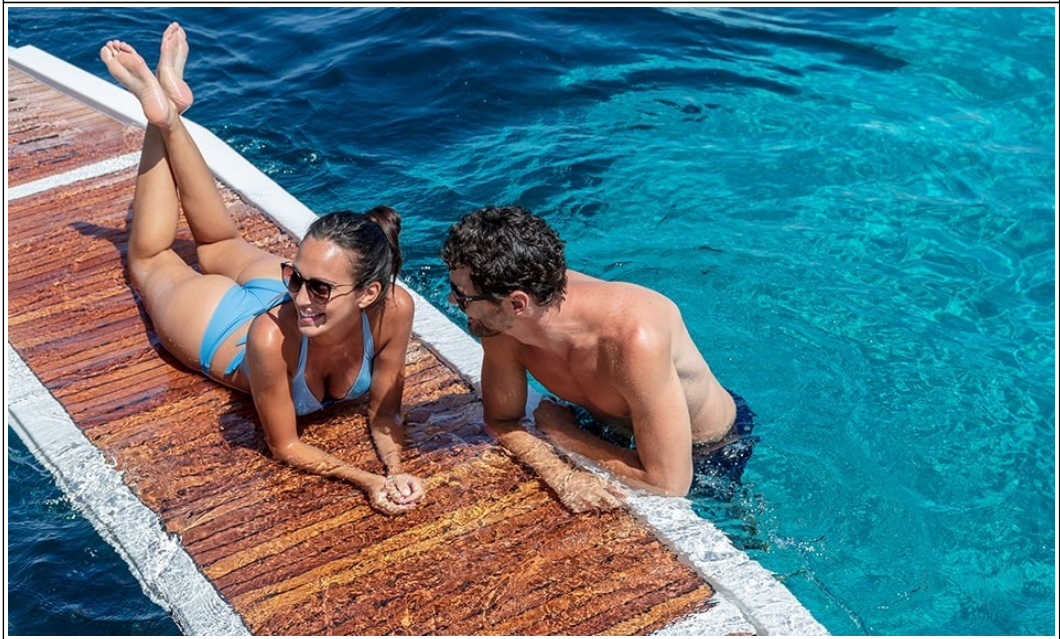



Disclaimer

The Company offers the details of this vessel in good faith but cannot guarantee or warrant the accuracy of this information nor warrant the condition of the vessel. A buyer should instruct his agents, or his surveyors to investigate such details as the buyer desired validated. This vessel is offered subject to prior sale, price change, or withdrawal without notice. Photos may not properly reflect the current condition of the actual vessel offered for sale. In some cases stock photographs may have been used.

Mechanical Disclaimer

Engine and generator hours are as of the date of the original listing and are a representation of what the listing broker is told by the owner and/or actual reading of the engine hour meters. The broker cannot guarantee the true hours. It is the responsibility of the purchaser and/or his agent to verify engine hours, warranties implied or otherwise and major overhauls as well as all other representations noted on the listing.

Dinghy Disclaimer

All dinghies are considered separate vessels and should have separate titles and documents. There is no guarantee as to the title of the dinghy on this vessel so Buyer accepts that while he may receive the dinghy included in the transaction, he may not receive the proper title to it.